

6.2mm (.244") Pitch Wire-to-Wire L Connector/Terminal

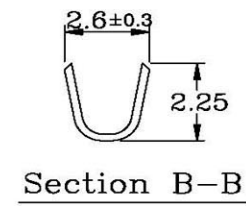
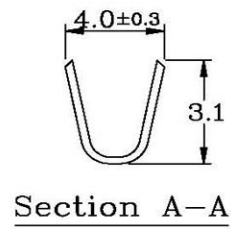
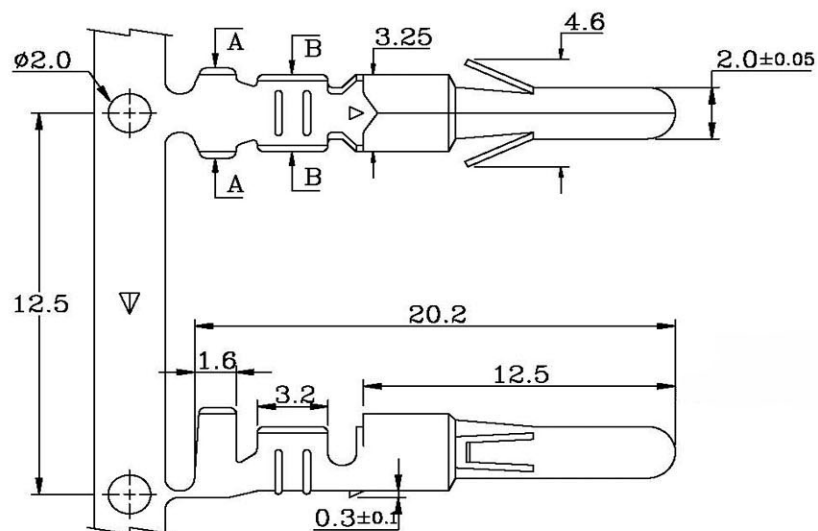

Specifications & Ordering Information

Thickness	Material	Wire Range	Insulation O.D.	Finish	Qty/reel
0.25	Brass	AWG #18-22	2.8-2.4 mm	Pre. Tin-Plated	5,000

RoHS
Compliant

HSM 玄茂科技股份有限公司
HSUAN MAO TECHNOLOGY CO., LTD.

APPD. 核准	HELEN	SCALE 比例 参考	TOLERANCE 容許公差 0 ± 0.25 .00 ± 0.13 ANG ±	PART NAME 品名 φ 2.00mm MALE TERMINAL BRASS MATERIAL AWG18-22 ROHS LOW-LEAD
DWG. 製圖				
DATE 制表日 2008/4/24	UNIT 單位 MM	SIZE 紙張尺寸 A 4	REV. 版本 A	PART NO. 料號 T2020-TBD00000R
	PAGE 張數 1 OF 1			