

## BN 388

Cross recessed flat countersunk  
head screws  
Phillips H

DIN 965 A  
~ISO 7046  
~UNI 7688

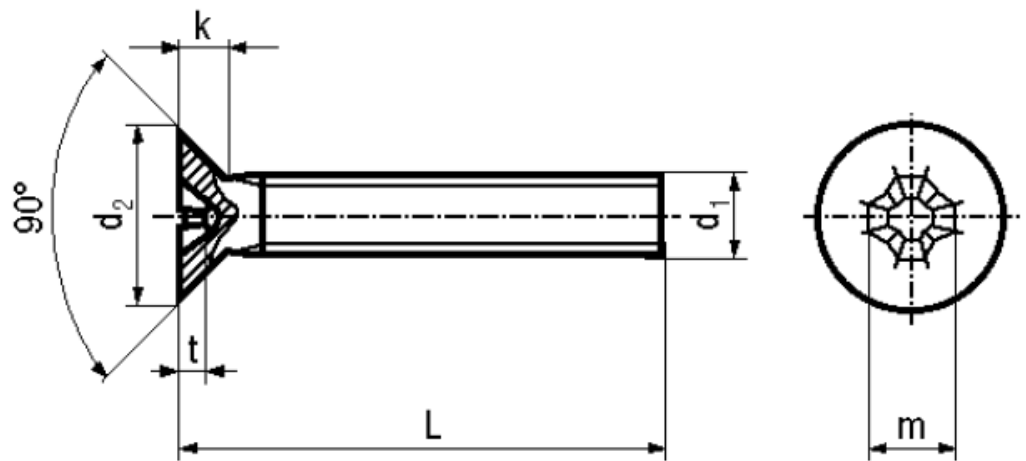

Material	<b>Steel</b>	Tensile strength	<b>400 N/mm<sup>2</sup></b>
Surface	<b>zinc plated blue</b>	Elongation after fracture	<b>min. 14%</b>
Quality	<b>4.8</b>		

### Article No. - 1156454

d <sub>1</sub>	M3
L	6
d <sub>2</sub> max.	5,6
k max.	1,65
Phillips	1
m~	2,9
t min.	1,5
t max.	1,8

DIN 965 A: Standard withdrawn and replaced under European standardization by the corresponding ISO standard.  
All lengths fully threaded.

DIN 965 A Prozidriv cross recess (Type Z) see BN 3333